

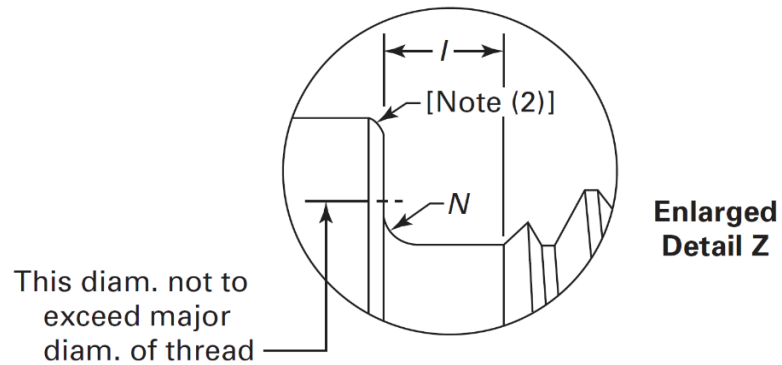

Socket Head Shoulder Screws

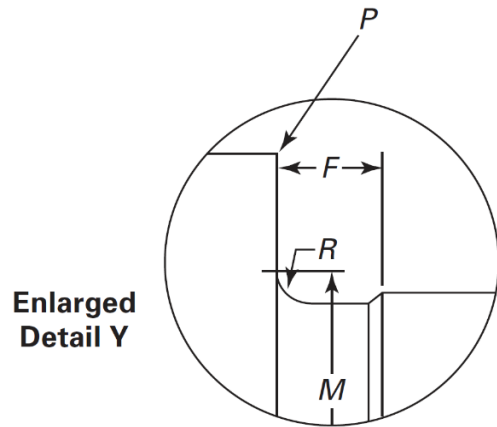

+1 (610) 904-8616
 sales@nickel-systems.com
 www.nickel-systems.com

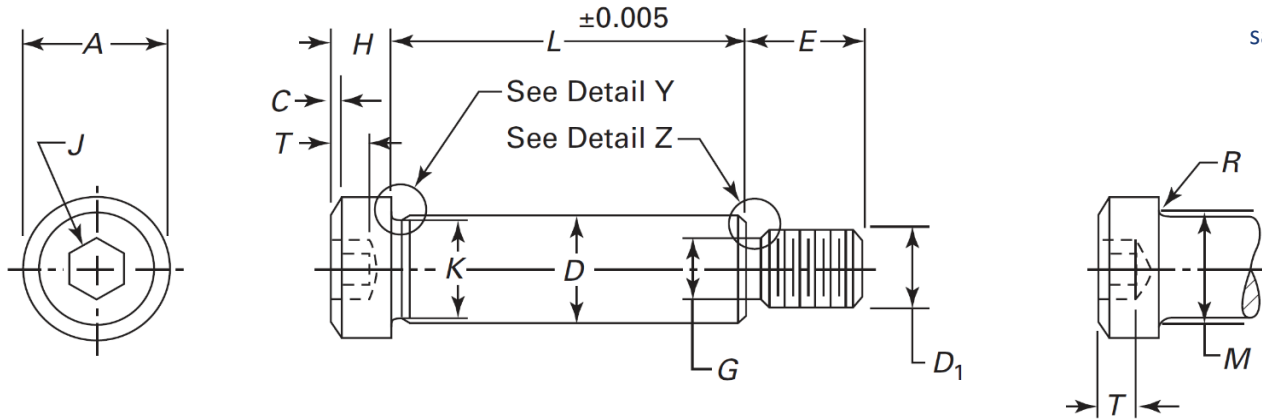

General Notes

1. Screw Point Chamfer. The point shall be flat or slightly concave, and chamfered.
2. Edge of Shoulder. The edge of the shoulder may be broken.
3. Head diameter. The head may be plain or knurled.
4. Neck Under Shoulder. The neck under the shoulder shall allow the shoulder to seat against the face of a standard basic GO thread ring gage.



Socket Head Shoulder Screws



+1 (610) 904-8616

sales@nickel-systems.com

www.nickel-systems.com

ASME B18.3 - 2012

Nominal Size (Basic Shoulder Diameter)	D		A		H		C Max. Chamfer or Radius	J		T Min. Key Engagement	M Fillet Transition Diameter	R Min. Head Fillet Radius	
	Shoulder Diameter		Head Diameter		Head Height			Nominal Hexagon Socket Size					
	Max.	Min.	Max.	Min.	Max.	Min.							
1/8	0.1250	0.123	0.121	0.250	0.2350	0.125	0.115	0.008	5/64	0.078	0.067	0.138	0.006
5/32	0.1560	0.154	0.152	0.281	0.2660	0.125	0.115	0.008	3/32	0.094	0.067	0.172	0.007
3/16	0.1875	0.185	0.183	0.312	0.2960	0.156	0.146	0.012	3/32	0.094	0.079	0.207	0.008
1/4	0.2500	0.248	0.246	0.375	0.3570	0.188	0.177	0.020	1/8	0.125	0.094	0.276	0.009
5/16	0.3125	0.311	0.309	0.438	0.4190	0.219	0.209	0.026	5/32	0.156	0.117	0.345	0.012
3/8	0.3750	0.373	0.371	0.562	0.5430	0.25	0.240	0.031	3/16	0.188	0.141	0.413	0.015
1/2	0.5000	0.498	0.496	0.750	0.7290	0.312	0.302	0.040	1/4	0.250	0.188	0.550	0.020
5/8	0.6250	0.623	0.621	0.875	0.8530	0.375	0.365	0.050	5/16	0.312	0.234	0.687	0.024
3/4	0.7500	0.748	0.746	1.000	0.9770	0.5	0.490	0.069	3/8	0.375	0.281	0.826	0.030
1	1.0000	0.998	0.996	1.312	1.2870	0.625	0.610	0.083	1/2	0.500	0.375	1.098	0.040
1-1/4	1.2500	1.248	1.246	1.750	1.7230	0.75	0.735	0.102	5/8	0.625	0.469	1.368	0.050
1-1/2	1.5000	1.498	1.496	2.125	2.0950	1	0.980	0.138	7/8	0.875	0.656	1.638	0.060
1-3/4	1.7500	1.748	1.746	2.375	2.3450	1.125	1.105	0.157	1.000	1.000	0.750	1.908	0.070
2	2.0000	1.998	1.996	2.750	2.7200	1.25	1.230	0.176	11/4	1.250	0.937	2.178	0.080



Socket Head Shoulder Screws



+1 (610) 904-8616

sales@nickel-systems.com

www.nickel-systems.com

ASME B18.3 - 2012

Nominal Size (Basic Shoulder Diameter)		K	F	D ₁		Threads, in.	G		I	N		E	P
		Min. Shoulder Neck Diameter	Max. Shoulder Neck Width	Nominal Thread Diameter			Thread Neck Diameter		Max. Thread Neck Width	Thread Neck Fillet		Basic Thread Length	Max. Chamfer or Radius
							Max.	Min.		Max.	Min.		
1/8	0.1250	0.108	0.040	4	0.1120	40	0.076	0.069	0.078	0.016	0.010	0.157	0.008
5/32	0.1560	0.140	0.040	6	0.1380	32	0.100	0.093	0.063	0.018	0.012	0.187	0.008
3/16	0.1875	0.154	0.040	8	0.1640	32	0.120	0.112	0.069	0.018	0.012	0.189	0.008
1/4	0.2500	0.227	0.093	10	0.1900	24	0.142	0.133	0.083	0.023	0.017	0.375	0.010
5/16	0.3125	0.289	0.093	1/4	0.2500	20	0.193	0.182	0.100	0.028	0.022	0.438	0.010
3/8	0.3750	0.352	0.093	5/16	0.3125	18	0.249	0.237	0.111	0.031	0.025	0.500	0.010
1/2	0.5000	0.477	0.093	3/8	0.3750	16	0.304	0.291	0.125	0.035	0.029	0.625	0.010
5/8	0.6250	0.602	0.093	1/2	0.5000	13	0.414	0.397	0.154	0.042	0.036	0.750	0.015
3/4	0.7500	0.727	0.093	5/8	0.6250	11	0.521	0.502	0.182	0.051	0.045	0.875	0.015
1	1.0000	0.977	0.125	3/4	0.7500	10	0.638	0.616	0.200	0.055	0.049	1.000	0.020
1-1/4	1.2500	1.227	0.125	7/8	0.8750	9	0.750	0.726	0.222	0.062	0.056	1.125	0.020
1-1/2	1.5000	1.478	0.125	1-1/8	1.1250	7	0.964	0.934	0.286	0.072	0.066	1.500	0.020
1-3/4	1.7500	1.728	0.125	1-1/4	1.2500	7	1.089	1.059	0.286	0.072	0.066	1.750	0.020
2	2.0000	1.978	0.125	1-1/2	1.5000	6	1.307	1.277	0.333	0.102	0.096	2.000	0.020

